

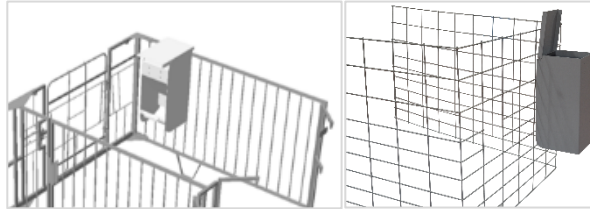

## CT-3000SS & CT-3000PC Grain Feeder

Inside or Outside Hang  
Stainless Steel & Powder Coat  
Assembly Instructions



### Calf-Tel Grain Feeder Inside & Outside Hang Bill of Material:

Item	Item Number	Description	Qty
1	CT-3000SS or CT-3000PC	Main Body	1
2	CT-3001SS or CT-3001PC	Cover	1
3	CT-3003SS or CT-3003PC	Rain Guard	1
4	CT-3005SS or CT-3005PC	Inside Hang Long Bracket	1
5	CT-3002SS or CT-3002PC	Inside or Outside Hang Large Bracket	1
6	CT-3004SS or CT-3004PC	Outside Hang Small Bottom Bracket	1
7	CT-HDWE-048SS or CT-HDWE-048PC	Short Bolt-Hardware Kit	1
8	CT-HDWE-043	Long Bolt-Hardware Kit (for Rain Guard)	1

#### Tools Needed:

1. ½ in (12.7 mm) Deep Socket with Ratchet
2. ½ in (12.7 mm) Wrench

### Inside Hang Installation Instructions:

**Step 1: Attach Cover to Grain Feeder:** Place cover over top opening of grain feeder. Line holes on cover up with holes on side of grain feeder.

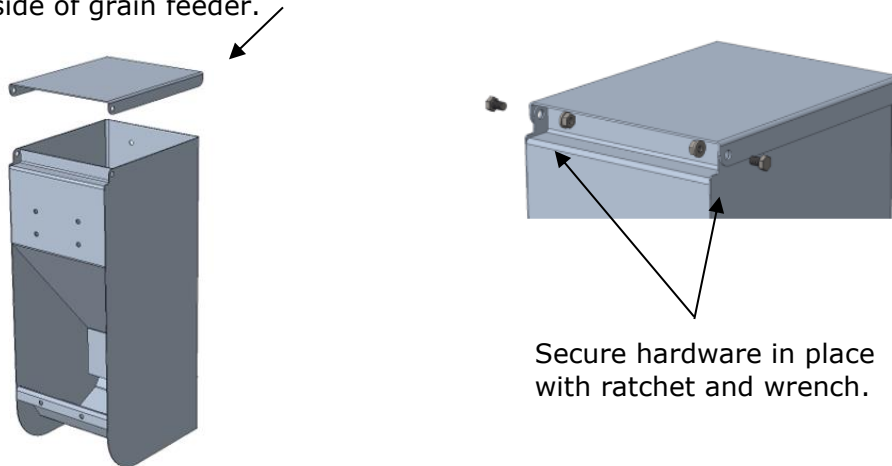



**Step 2: Assemble Long Bracket to Grain Feeder:** Depending on fence system, determine which long bracket to assemble to grain feeder. Using hardware, ratchet and wrench, insert screw into feeder, tighten nut from the outside of feeder.

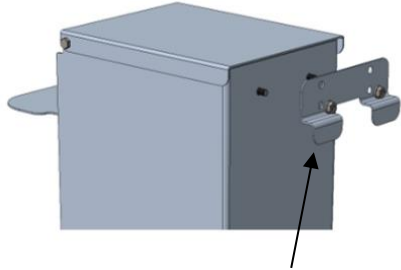

Bracket Option 1 (CT-3002SS OR CT3002PC)  
Calf feed opening 23" off ground

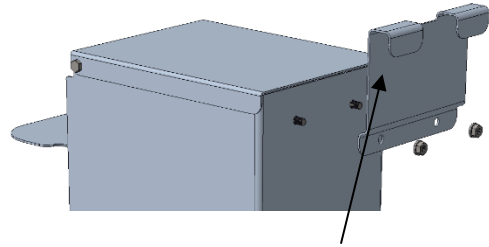

Bracket Option 2 (CT-3005SS or CT-3005PC)  
Calf feed opening 18" off ground

**Step 3: Install Rain Guard Over Calf Feed Opening:** Align rain guard holes with two top holes on grain feeder above calf feed opening. Using CT-HDWE-043 (Long Bolt Hardware) insert bolts through rain guard plate into grain feeder and tighten from inside until bolts lock in.

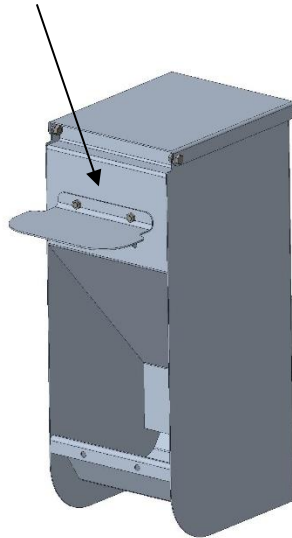



## **Outside Hang Installation Instructions:**

**Step 1: Attach Cover to Grain Feeder:** Place cover over top opening of grain feeder. Line holes on cover up with holes on side of grain feeder.

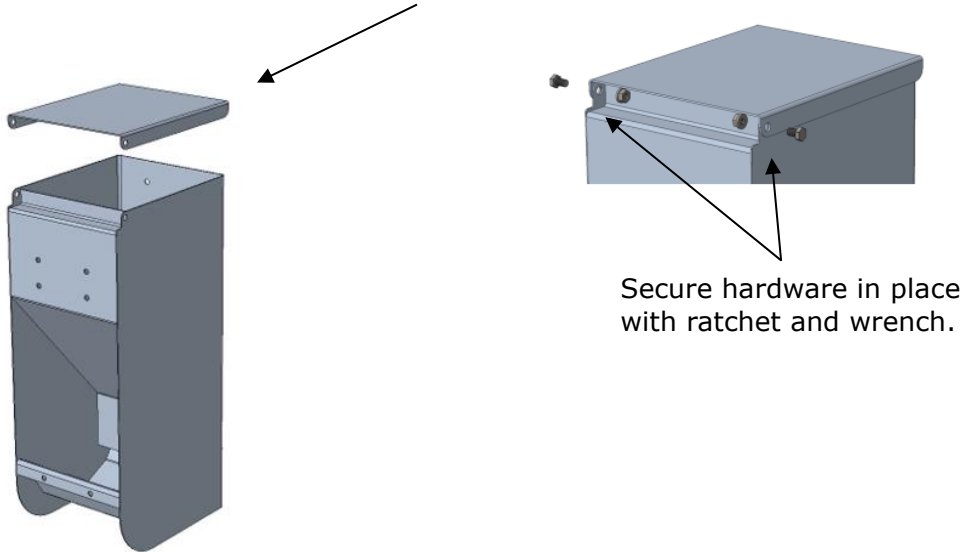

### **Step 2: Assemble Small Bracket to Grain Feeder:**

Using hardware, ratchet and wrench, attach lower, small bracket to grain feeder. Bracket should sit below calf feed opening.

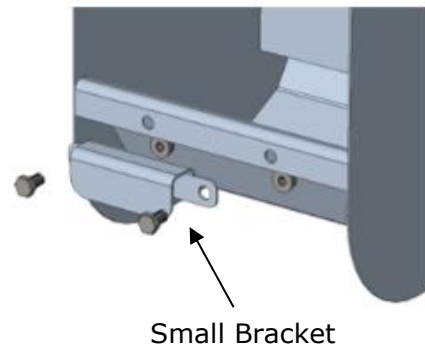

### **Step 3: Install Large Bracket and Rain Guard Over Calf Feed Opening:**

Place large bracket onto grain feeder, align rain guard holes with two top holes on grain feeder. Rain Guard will sit over large bracket. From inside of grain feeder, using CT-HDWE-043 (Long Bolt Hardware) insert bolts through rain guard plate into grain feeder and tighten from inside until bolts lock in. Secure with nut from outside.

